

CO₂ Sensor Module Installation Guide

Before you Start

Read this section in its entirety before installing the CO₂ sensor module to the Room Controller. Failure to follow the instructions in this section can cause permanent damage to the CO₂ sensor module and Room Controller.

ESD Protection

The CO₂ sensor module is an electronic device sensitive to Electrostatic Discharges. Always ensure you are properly connected to GND before handling the Room Controller and CO₂ sensor module. Use high caution when handling the CO₂ sensor module and avoid any contact with grey housing on CO₂ sensor module. Never apply pressure (bending PCB) on the module.

Back Plate Screw

The CO₂ sensor module may come in contact with the TOP screw on the back plate of the Room Controller. Perform one of the following counter-measures:

- remove screw and install it in the hole located at the top of the back plate.
- if using lower hole, replace screw with a flat head nylon screw and ensure screw is lower than plastic edges on CO₂ sensor module.

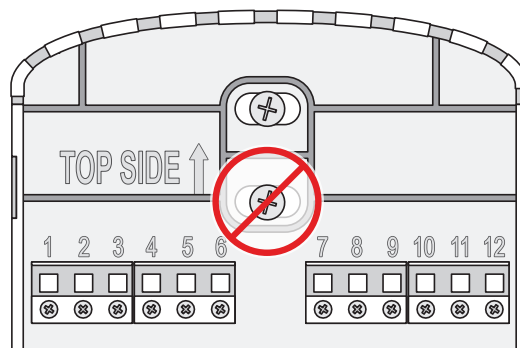

Operation

The CO₂ sensor module gets activated approximately 30 seconds after power is applied to the Room Controller. To ensure correct installation of the CO₂ sensor module, navigate to CO₂ sensor screen on Room Controller and validate the correct serial number and Firmware version are displayed.

The CO₂ sensor module has an auto-calibration feature and may require up to 3 weeks of operation before the module reaches full accuracy. Full accuracy should be sufficient after 1 week of operation. The CO₂ sensor module will continuously calibrate itself over time and no other maintenance is required. It is necessary for the space/zone/room to have a non-occupancy period of several hours every week to maintain full accuracy of the CO₂ sensor module.

Install CO₂ Sensor Module

1. Remove security screw on bottom of Room Controller (if necessary) and remove top plate from back plate (Figure 1).

NOTE: some Room Controller models do not have security screw.

2. Align connector pins of CO₂ sensor module with holes on PC board (Figure 2).

NOTE: ensure alignment of pins is precise so as to not damage CO₂ sensor module.

3. Place your fingers on pressure points of CO₂ sensor module and gently press into PC board until it fits snugly and is flush with PC board (Figure 3 and Figure 4).

NOTE: never press on CO₂ sensor module directly. Always press on pressure points shown in Figure 3.

4. Gently align top plate with back plate and snap in place from bottom (Figure 5) and install security screw (if necessary).

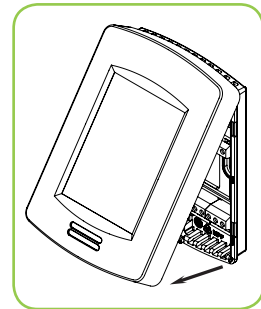

Figure-1

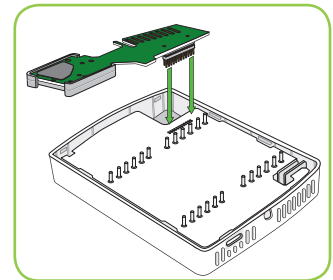

Figure-2

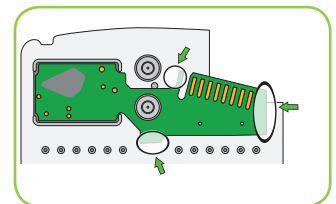

Figure-3

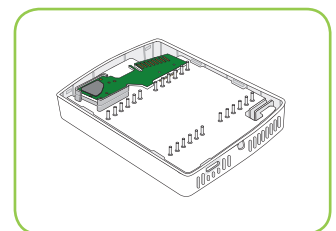

Figure-4

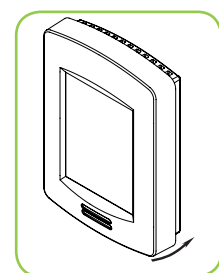

Figure-5

Remove CO₂ Sensor Module

1. Remove security screw on bottom of Room Controller (if necessary) and remove top plate from back plate (Figure 1).

2. Place your fingers on pressure points and gently lift CO₂ sensor module out of PC board (Figure 3 and Figure 2).

NOTE: Never press or apply any pressure to CO₂ sensor module. Always lift CO₂ sensor module out of PC board from pin side only. Always place fingers on pressure points as shown in Figure 3. Applying any pressure directly on CO₂ sensor module can cause permanent damage.

3. Gently align top plate with back plate and snap in place from bottom and install security screw if necessary (Figure 5).